



REF: # 6733

ORIHUELA COSTA (LAS PHILIPINAS)



INFO

PRECIO: 600.000 €

TIPO: Villa

CIUDAD: Orihuela
Costa (Las
Philipinas)

HABITACIONES: 3

Baños: 4

Construidos (m2): 150

Parcela (m2): 1.765

Terraza (m2): 157

Años:

Planta: -

MENSAJE -

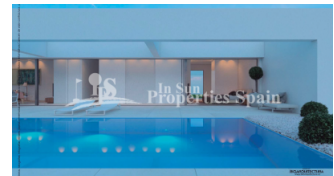
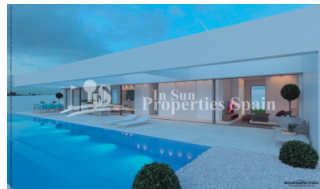
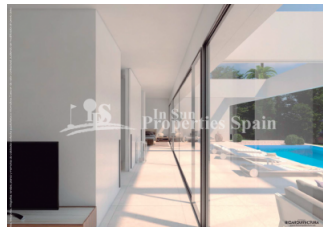
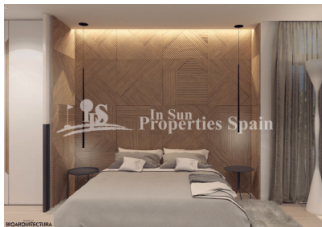

DESCRIPCION

A new exclusive project in urbanisation Las Filipinas, VILLAMARTIN. Here you have the option of designing the most amazing one level 150m2 (approx) detached luxury Villa within this outstanding 1765m2 plot based on a number of options. Option 1 (with or without Pergola) boasts a detached Villa with 3 bedrooms, 2 bathrooms and 2 guest toilets, open plan modern contemporary accommodation comprising of light and airy lounge, family dining area, sleek fitted and fully furnished kitchen with quality finish, separate laundry room, 2 double bedrooms and a master suite plus study area. In total there are 85m2 of terraces and a 72m2 sunny rooftop solarium not to forget the impressive 42m2 private swimming pool. There is parking for a number of vehicles and a southwest orientation. Option 2 would boast 2 levels, price for this option is upon consultation. Villamartin offers a wide range of services. For over 40 years it has been a golf tourist attraction and as it is expected from a residential complex of this standard all services are fully developed. The

area is also known to have one of the healthiest climates in the world. Villamartin is also very close to renowned high standard international school El Limonar and La Zenia Boulevard - the newest shopping centre in our area and also the largest one in the Alicante region. At over 160,000m2 It offers more than 150 shops and services including a huge supermarket Alcampo, Leroy Merlin, Primark, Swarovski, Decathlon, Massimo Dutti, Zara, Stradivarius and much more. There are many commercial centers including the well know Villamartin Plaza and La Fuente Centre along with many restaurants, fashion shops, supermarkets, banks, pharmacies etc. Villamartin was built round one of the most prestigious golf courses on the Costa Blanca-Villamartín Golf Club- it is home to a Cosmopolitan and International community. Just a short distance away you can find 3 other golf courses such as Las Ramblas, Campoamor and La Finca. However, it is not only a golfers paradise, you can also find a large range of activities and entertainment for all the family; water parks in Torrevieja and Ciudad Quesada, 3km from some of the best beaches in the region, open weekly markets, cinemas etc. Villamartín is approximately 50 minutes from Alicante International and Murcia Corvera airport. By Train there are connections Madrid-Alicante (2:30 h) AVE Madrid-Murcia & Barcelona-Alicante (4.5 h)



ESTILO <ul style="list-style-type: none">ModernoContemporaneo	VISTAS <ul style="list-style-type: none">Panoramico	DISTANCIA A : <div>Playa : 3 Km</div> <div>Aeropuerto: 50 Km</div> <div>Ciudad : 500 m</div>	ORIENTACION <div>Sur oeste</div>
AMUEBLADO <ul style="list-style-type: none">Sin amueblar	PARKING NO. DE COCHES <div>: 2</div>	AREAS <ul style="list-style-type: none">TrasteroBaño en dormitorio	SUELO <ul style="list-style-type: none">AzulejosPiedra
COCINA <ul style="list-style-type: none">Cocina abiertaCocina equipadaGranito	JARDÍN Y TERRAZAS <ul style="list-style-type: none">Terraza cubiertaTerraza abiertaPaisajistaMuros de piedraJardín privado	EXTRA <ul style="list-style-type: none">Armarios empotradosPuerta de seguridadDoble cristalTrasteroLavanderia	



renders, plans and memories of qualities or effects, publicizing or informative, can be modified or modified, without being modified, in private view.



In Sun
Properties Spain

desarrollado por
BICARQUITECTURA
www.bicarquitectura.es



In Sun
Properties Spain

desarrollado por
BICARQUITECTURA
www.bicarquitectura.es

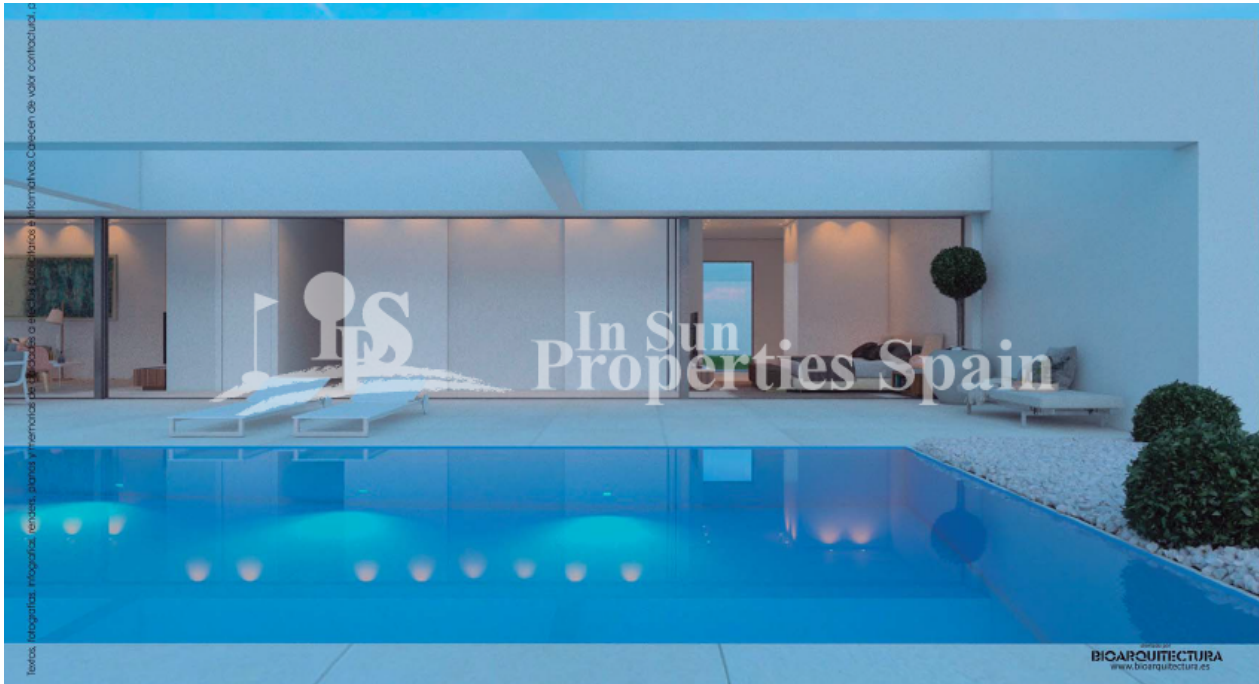

Textos, fotografías, infografías, renders, planos y memorias de calidades a efectos publicitarios e informativos. Crecen de valor contractual al ser modificados sin previo aviso.

In Sun
Properties Spain

Desarrollado por
BIOARQUITECTURA
www.bioarquitectura.es

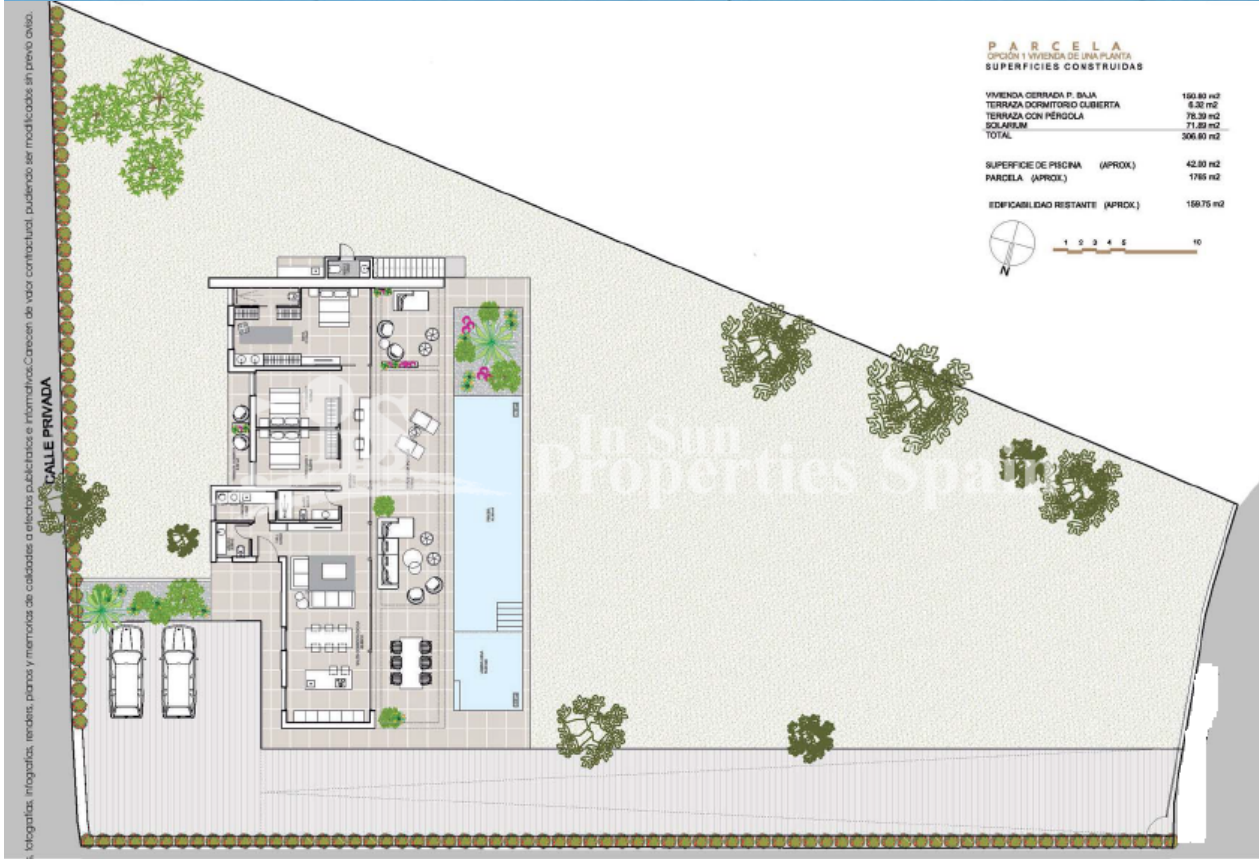

Textos, fotografías, infografías, renders, planos y memorias de calidades a efectos publicitarios e informativos. Crecen de valor contractual al ser modificados sin previo aviso.

PARCELA
OPCIÓN 1 VIVIENDA DE UNA PLANTA
SUPERFICIES CONSTRUIDAS

VIVIENDA CERRADA P. BAJA	150.80 m ²
TERRAZA DORMITORIO CUBIERTA	6.30 m ²
TERRAZA CON PÉRGOLA	78.30 m ²
SOLARIUM	71.80 m ²
TOTAL	306.80 m²

SUPERFICIE DE PISCINA	(APROX.)	42.93 m ²
PARCELA	(APROX.)	1785 m ²

EDIFICABILIDAD RESTANTE (APROX.)	158.75 m ²
----------------------------------	-----------------------



In Sun
Properties Spain

Desarrollado por
BIOARQUITECTURA
www.bioarquitectura.es

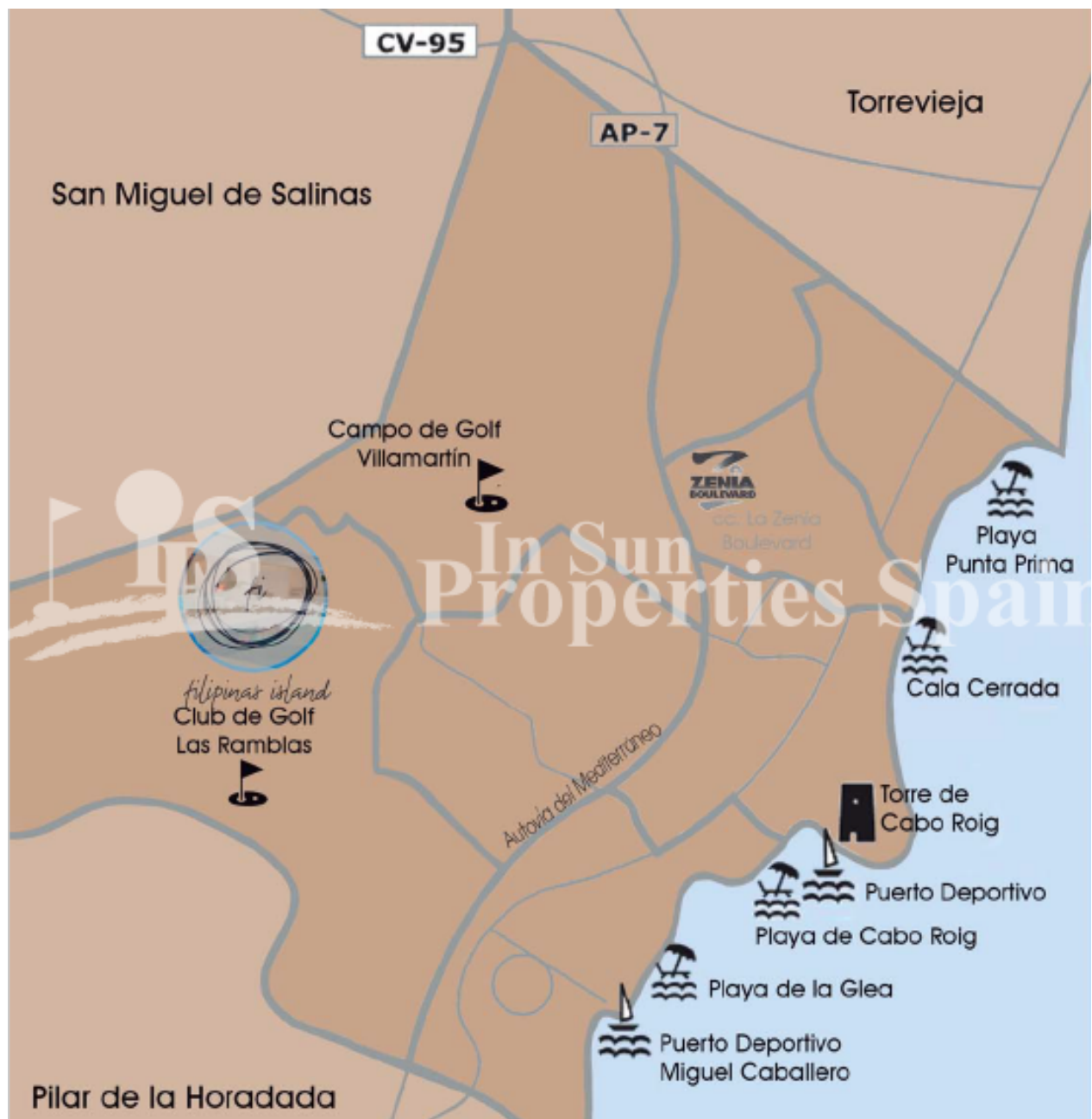







"OUR EXPERIENCE IS YOUR GUARANTEE"