



REF: # 6717

COSTA MURCIA (SAN PEDRO DEL PINATAR)



INFO

PRECIO:	245.950 €
TIPO:	Apartamento
CIUDAD:	Costa Murcia (San Pedro del Pinatar)
HABITACIONES:	3
Baños:	2
Construidos (m2):	98
Parcela (m2):	-
Terraza (m2):	6
Años:	
Planta:	-
MENSAJE	-

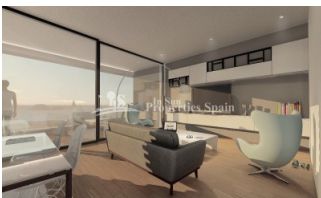

DESCRIPCION

New beachfront boutique Apartment development in SAN PEDRO with stunning beach and sea views from the terraces. Generous build sizes from 98m2 and an open plan living space with the option to customise the Apartment with either 2 or 3 bedrooms. They boast open living area, fitted kitchen with oven, hob and extractor hood, 2 bathrooms and terrace. There is the option to have a garage space for an additional €150000 and an optional storage room (perfect for housing all of the beach equipment) for an additional €4000. The two Penthouse Apartments are already SOLD. Remaining Apts are on the 1st or 2nd floor but the development is Lift assisted. Lo Pagan is situated on the north shore of the Mar Menor with a beautiful beach, promenade and small marina. During the summer months there is a lively funfair beside the marina which adds to the seaside atmosphere. Lo Pagan is most famous for its mud baths. These are free and are located at the end of the beach and the start of the salinas walking and cycling route out to

sea. When you own a home in this region we would recommend a visit Cabo de Palos, Punta Brava or any of the other interesting towns and villages on the Mar Menor.



ESTILO	VISTAS	DISTANCIA A :	ORIENTACION
<ul style="list-style-type: none"> Moderno Contemporaneo 	<ul style="list-style-type: none"> Panoramico Vistas al mar 	Playa : 50 m Aeropuerto: 40 Km Ciudad : 100 m	Sur
AMUEBLADO	PARKING NO. DE COCHES	AREAS	SUELO
<ul style="list-style-type: none"> Sin amueblar 	: 1	<ul style="list-style-type: none"> Trastero 	<ul style="list-style-type: none"> Azulejos Piedra
COCINA	JARDÍN Y TERRAZAS	EXTRA	CERTIFICADO ENERGETICO
<ul style="list-style-type: none"> Cocina abierta Cocina equipada 	<ul style="list-style-type: none"> Terraza abierta 	<ul style="list-style-type: none"> Puerta de seguridad Doble cristal Ascensor 	<p>The image shows a vertical energy efficiency scale with seven horizontal bars labeled A through G. Bar A is dark green, B is green, C is light green, D is yellow, E is orange, F is red-orange, and G is red. To the right of these bars is a vertical green bar with the text 'EN TRAMITES' written vertically.</p>

"OUR EXPERIENCE IS YOUR GUARANTEE"